

Connettori filo-scheda

Connettori per schede passo 2.54mm terminali per circuito stampato

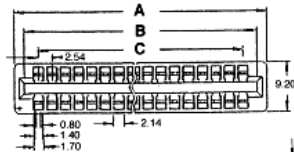
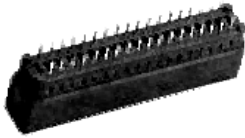

Art.	poli	A	B	C
G-D0820SA1	2X10	32.00	28.14	22.86
G-D0836SA1	2X18	52.32	48.46	43.18
G-D0831SA1	2X31	84.46	81.40	76.20
G-D0849SA1	2X49	138.85	134.80	129.54

Connettori per schede passo 2.54mm

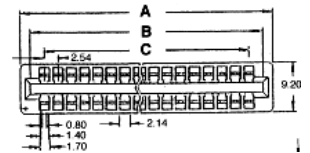

terminali circuito stampato

Art.	poli	A	B	C
A254/2X22L	2X22	62.48	58.32	53.34
A254/2X24L	2X24	65.56	63.40	58.42
A254/2X30L	2X30	82.80	79.00	73.66
A254/2X36L	2X36	84.46	81.40	76.20
A254/2X37LA	2X37	87.00	83.94	78.74
A254/2X43L	2X43	115.82	111.66	106.68
A254/2X50L	2X50	133.60	129.44	124.46

Connettori per schede passo 2.54mm terminali a 90°

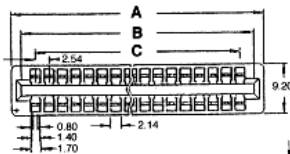

Art.	poli	A	B	C
G-D0812SB1RA	2X6	21.84	17.98	12.70
G-D0898SB1RA	2X49	138.85	134.80	129.54

Connettori per schede passo 2.54mm

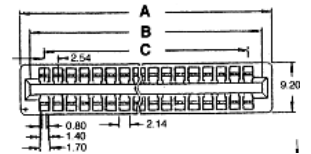

terminali a saldare

Art.	poli	A	B	C
A254/2X37LS	2X37	87.00	83.94	78.74

Connettori per schede passo 2.54mm terminali per circuito stampato

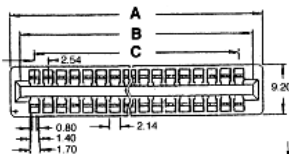

Art.	poli	A	B	C
A254/2X25	2X25	70.10	66.04	60.96
A254/2X31	2X31	84.46	81.40	76.20

Connettori per schede passo 2.54mm



Art.	Polì
A254/2X25MS	2X25
A254/2X37FA	2X37

Connettori per schede passo 3.96mm

Connettori per schede passo 2.54mm

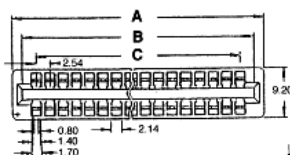

terminali wire wrap

Art.	poli	A	B	C
A254/2X20	2X20	57.40	53.24	48.26

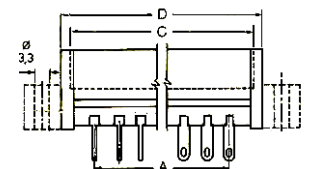

terminali a saldare

Art.	poli	A	C	D
A396/1X15LS	1X15	55.5	62.4	67.4
A396/1X30LSA	1X30	114.9	121.9	127.0
A396/1X36LSA	1X36	138.7	145.6	150.7

Connettori filo-scheda

Connettori per schede passo 3.96mm terminali a saldare

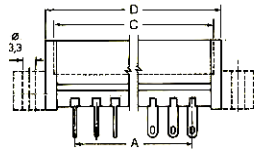

Art.	poli	A	C	D
A396/2X10LSA	2X10	35.7	42.6	47.6
A396/2X15LS	2X15	55.5	62.4	67.4
A396/2X15LSA	2X15	55.5	62.4	67.4
A396/2X18LS	2X18	67.4	74.3	79.3
A396/2X18LSA	2X18	67.4	74.3	79.3
A396/2X18LSAX	2X18	67.4	74.3	79.3
A396/2X22LS	2X22	83.2	90.2	95.2
A396/2X31LSA	2X31	118.9	125.8	130.9

* lettera A finale prodotto AMP

Connettori per schede passo 3.96mm terminali da circuito stampato

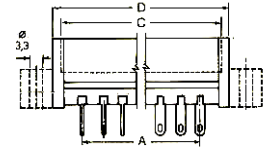

Art.	poli	A	C	D
A396/2X10LCA	2X10	35.7	42.6	47.6
A396/2X18LC	2X18	67.4	74.3	79.3
A396/2X18LCA	2X18	67.4	74.3	79.3
A396/2X18LCAX	2X18	67.4	74.3	79.3
A396/2X22LC	2X22	83.2	90.2	95.2
A396/2X22LCW	2X22	83.2	90.2	95.2
A396/2X36LCA	2X36	138.7	145.6	150.7
A396/2X43LCA	2X43	166.4	173.4	178.4
A396/2X50LCA	2X50	194.2	201.1	206.2

* lettera A finale prodotto AMP

Connettori per schede passo 3.96mm terminali da circuito stampato

Connettori per schede passo 3.96mm terminali da circuito stampato

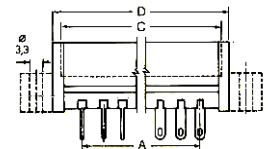
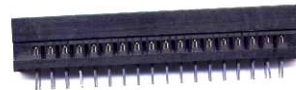
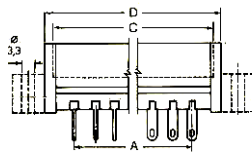

Art.	poli	A	C	D
A396/2X18	2X18	67.4	74.3	79.3

Art.	poli	A	C	D
A396/1X18	1X18	67.4	74.3	79.3
A396/1X18LCA	1X18	67.4	74.3	79.3
A396/1X30LCA	1X30	114.9	121.9	127.0
A396/1X36LCA	1X36	138.7	145.6	150.7

* lettera A finale prodotto AMP

Connettori filo-scheda

Connettore femmina 5 poli per commutatori digitali



Art.
AW355

Connettori per schede passo 2.54mm per cavo piatto T&B

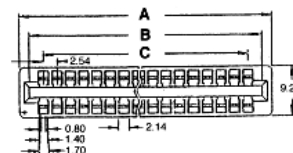

Orecchiette di fissaggio per connettori passo 3.96mm AMP



Art.
A1632572

Art.	poli	A	B	C
A255/2X10T	2X10	32.00	28.14	22.86
A255/2X17LT	2X17	49.75	45.92	40.64
A255/2X20LT	2X20	57.40	53.24	48.26
A255/2X20T	2X20	57.40	53.24	48.26
A255/2X30T	2X30	82.80	79.00	73.66

* lettera L nel codice = con orecchiette a sbalzo

Connettori per schede passo 2.54mm per cavo piatto T&B

Chiavetta di polarizzazione



Art.
A881141

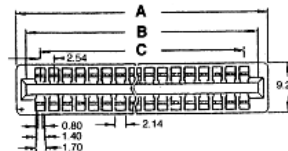

Chiavetta di polarizzazione



Art.
A881141

Art.	poli	A	B	C
A255/2X7LA	2X7	29.00	21.00	15.00
A255/2X10	2X10	32.00	28.14	22.86
A255/2X13	2X10	32.00	28.14	22.86
A255/2X13LA	2X13	39.62	35.56	30.48
A255/2X17	2X17	49.75	45.92	40.64
A255/2X20LA	2X20	57.40	53.24	48.24
A255/2X20	2X20	57.40	53.24	48.24
A255/2X25LA	2X25	70.10	66.04	60.96

* lettera L nel codice = con orecchiette a sbalzo

Chiavetta di polarizzazione per connettori T&B per cavo piatto



Art.
AW355